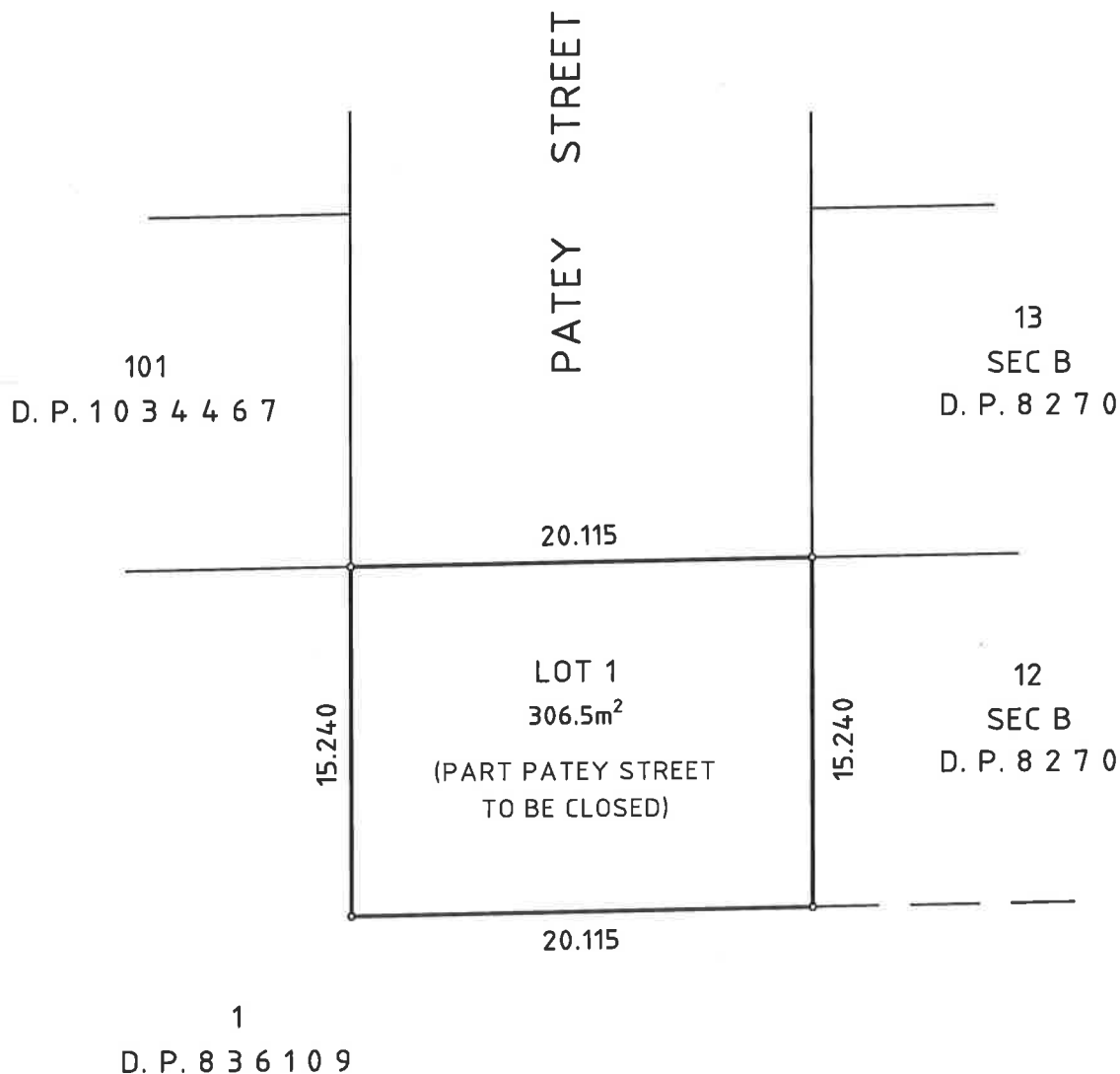

DIAGRAM SHOWING PROPOSED ROAD CLOSURE  
OF PART OF PATEY STREET  
AT DEE WHY

DATE: 15 APRIL, 2013



"DELMAR PRIVATE HOSPITAL"

DUNLOP THORPE & CO. Pty. Limited  
REGISTERED SURVEYORS  
447 KENT STREET, SYDNEY 2000  
Tel. 9283 6677  
Fax. 9283 6633

SURVEYORS REF: 16119-6

PLAN OF PROPOSED RIGHT OF CARRIAGEWAY  
 WITHIN SITE OF ROAD CLOSURE  
 DELMAR PRIVATE HOSPITAL  
 PATEY STREET, DEE WHY

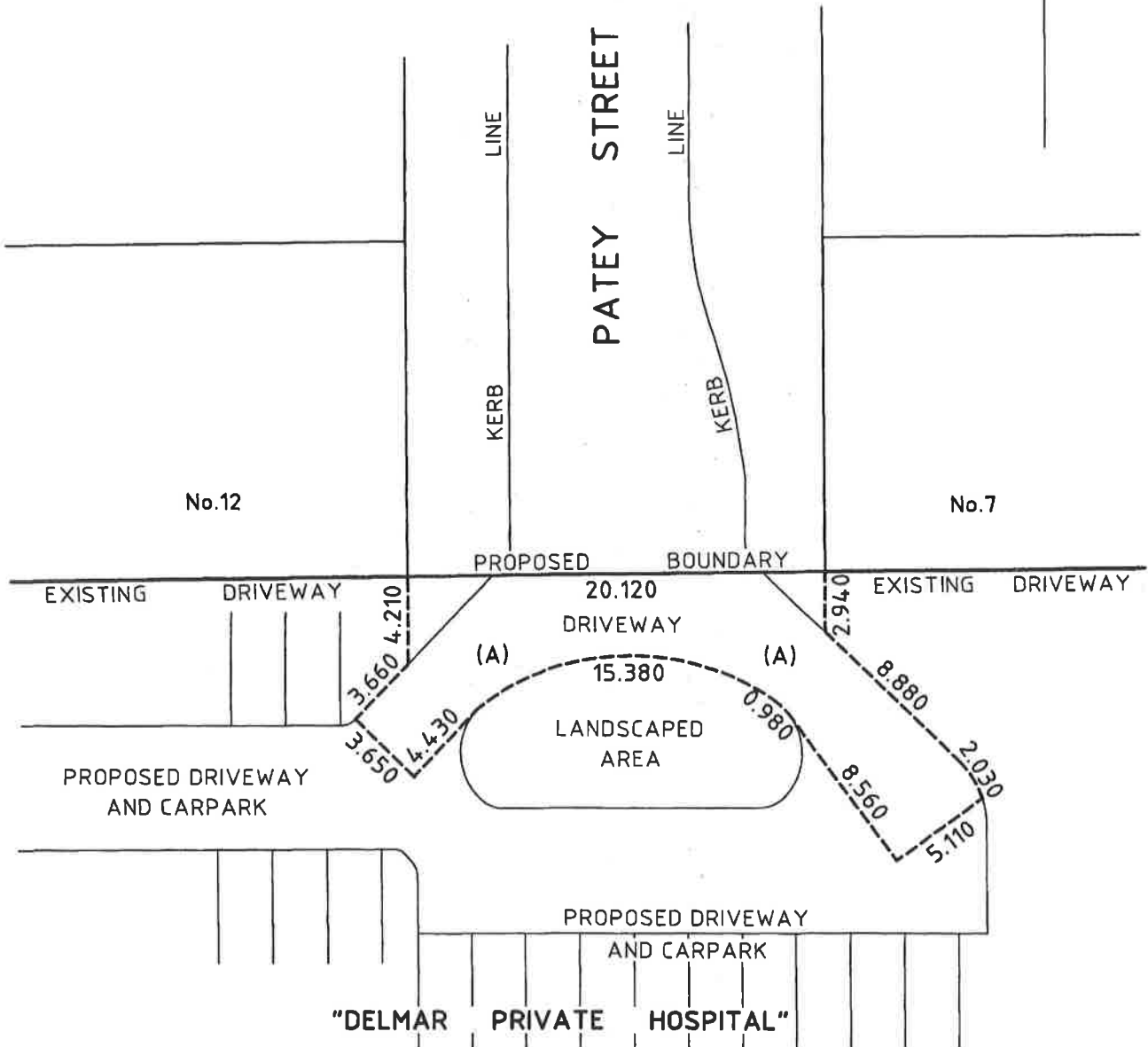

(A) PROPOSED RIGHT OF CARRIAGEWAY  
 (VARIABLE WIDTH)

AREA OF PATEY STREET PROPOSED TO BE CLOSED 306.7m<sup>2</sup>

TOTAL AREA OF RIGHT OF CARRIAGEWAY 159.4m<sup>2</sup>

COMPRISING,

AREA WITHIN SITE OF ROAD CLOSURE 112.7m<sup>2</sup>  
 AREA WITHIN CURRENT DELMAR LAND 46.7m<sup>2</sup>

**DUNLOP THORPE & CO.** Pty. Limited  
 REGISTERED SURVEYORS

447 KENT STREET, SYDNEY 2000

Tel. 9283 6677

Fax. 9283 6633

1 NOVEMBER 2011

SURVEYORS REF: 16119-5