

NOTES:

1. ALL DIMENSIONS ARE IN MILLIMETRES AND ALL LEVELS ARE IN METRES RELATIVE TO AUSTRALIAN HEIGHT DATUM (AHD) APPROX 0.925m ABOVE CHART DATUM (CD).
2. THE LOCATION OF THE SWING MOORING POINTS HAS BEEN PROVIDED BY ROADS AND MARITIME SERVICES FROM A MOORING SURVEY UNDERTAKEN ON 12TH APRIL 2018.
3. SWING CIRCLE RADIUS SHOWN FOR EACH MOORING HAS BEEN ESTIMATED BASED ON THE ADDITION OF A NOMINAL VESSEL LENGTH OF 20m TO 1.5 TIMES THE WATER DEPTH BELOW CHART DATUM.
4. BELLS WHARF SURVEY TO AHD PROVIDED BY NORTHERN BEACHES COUNCIL DATED 1ST APRIL 2019.
5. BATHYMETRIC SURVEY TO AHD PROVIDED BY PORT AUTHORITY OF NSW DATED 28TH MARCH 2019.
6. SERVICES INFORMATION OBTAINED THROUGH DBYD, ENQUIRY DATED 11TH APRIL 2019 AND LOCATED ON SITE BY McLENNANS DIVING SERVICE 20TH JUNE 2019.

LEGEND:

- 900 WIDE FINGER PONTOON
400-500mm FREEBOARD
- LANDING PONTOON
500mm FREEBOARD
- 3000 WIDE WALKWAY PONTOON
500mm FREEBOARD
- 9000 LONG x 5000 WIDE PONTOON
700mm FREEBOARD
- APPROX EXTENT OF SEAGRASS
(ZOSTERA CAPRIORNI) AND MARINE ALGAE (CAULERPA TAXIFOLIA)
- EXISTING STRUCTURE TO BE DEMOLISHED
- DESIGN VESSEL:
5m LENGTH VESSEL WITH 2m BEAM

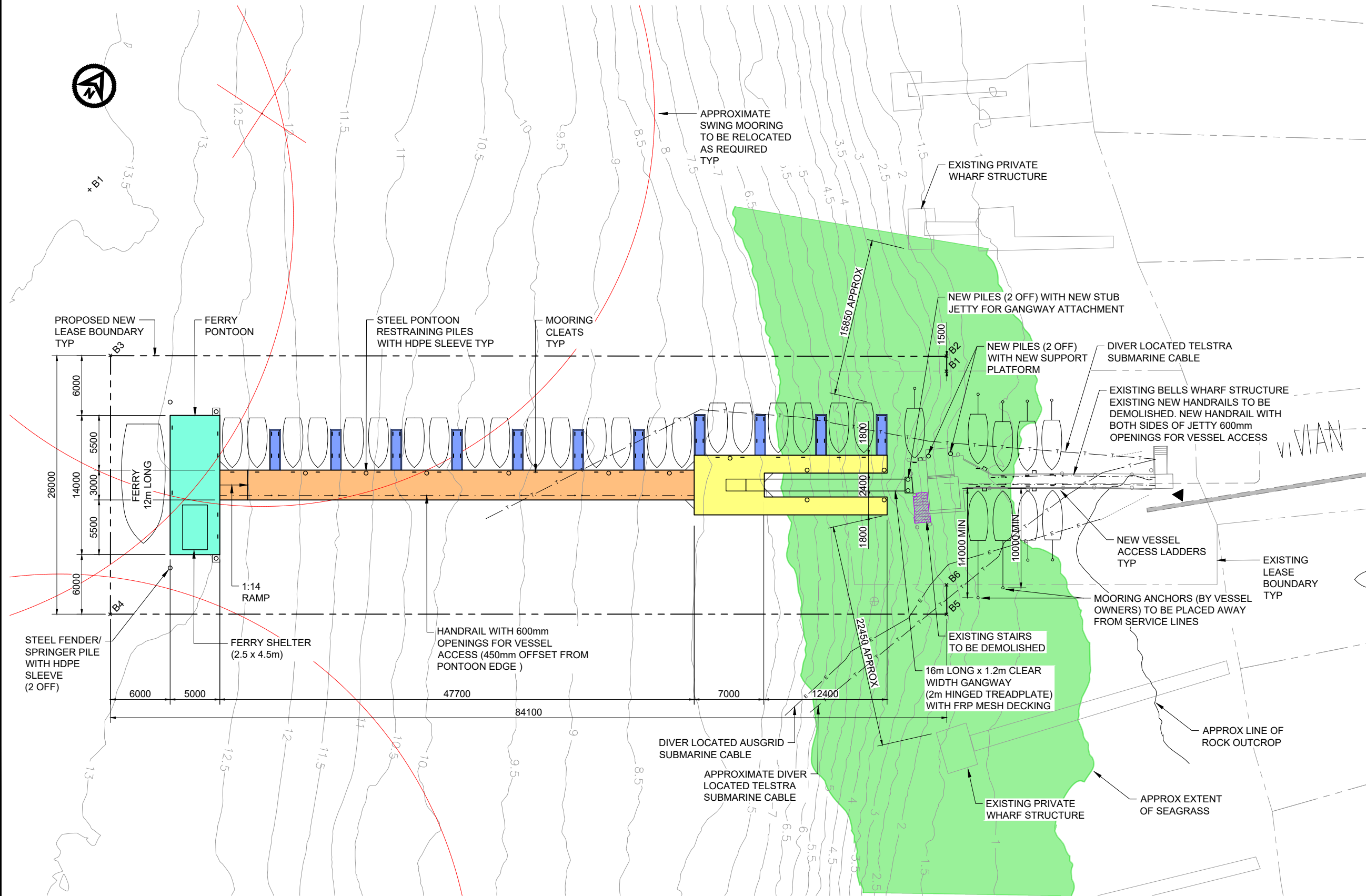

REV	DATE	DESCRIPTION	BY	CHK	APP
E	05.08.2019	NEW LEASE BOUNDARY COORDS ADDED	SC	SH	
D	06.07.2019	ARRANGEMENT AMENDED	SC	SH	
C	14.07.2019	ARRANGEMENT AMENDED	SC	SH	
B	14.06.2019	LEASE BOUNDARY DIMS ADDED	SC	SH	
A	10.06.2019	ISSUED FOR REVIEW	SC	SH	

REVISIONS

CLIENT

northern beaches council

PROJECT

SCOTLAND ISLAND WHARF FACILITY UPGRADE

TITLE

BELLS WHARF GENERAL ARRANGEMENT CONCEPT PLAN

Royal HaskoningDHV
Enhancing Society Together

Level 16, 56 Berry Street
North Sydney NSW 2060
Australia
Tel +61 2 98545000
Fax +61 2 99290960
Email: project.admin.australia@rhdhv.com
Website: www.royalhaskoningdhv.com

DRAWN	COORD. SYSTEM	DATUM	DATE
AT A1	AS SHOWN	SCOTLAND ISLAND	30.07.2019
DRAWING No.	REVISION		
PA1979-RHD-00-DR-MA-CP11	E		

PROPOSED NEW LEASE BOUNDARY COORDINATES

- B1 E 341099.575, N 6276316.860
- B2 E 341098.756, N 6276318.105
- B3 E 341028.458, N 6276271.962
- B4 E 341042.729, N 6276250.249
- B5 E 341112.998, N 6276296.435
- B6 E 341111.369, N 6276298.915

GENERAL ARRANGEMENT PLAN

1:200 (A1)

BERTH SCHEDULE

EXISTING	12
PROPOSED: FIXED MOORINGS	9
FLOATING MOORINGS	22
ROUGH WATER MOORINGS	0
TOTAL:	31

NOT FOR CONSTRUCTION

AUSTRALIAN HEIGHT DATUM

